

MIG/MAG Welding torches
TBi Expert



CONTENTS. TBI Expert

Gas cooled torches



TBi 150
Classic Series
60% (10 min.)
Mix: 150 A
CO₂: 180 A
Ø 0.6-1.0 mm

Page 4-5



TBi 240
Classic Series
60% (10 min.)
Mix: 220 A
CO₂: 250 A
Ø 0.8-1.2 mm

Page 6-7



TBi 250
Classic Series
60% (10 min.)
Mix: 200 A
CO₂: 230 A
Ø 0.8-1.2 mm

Page 8-9



TBi 260
Classic Series
60% (10 min.)
Mix: 240 A
CO₂: 270 A
Ø 1.0-1.2 mm

Page 10-11



TBi 360
Classic Series
60% (10 min.)
Mix: 300 A
CO₂: 330 A
Ø 1.0-1.6 mm

Page 12-13



TBi 7G
Top 2000 Series
60% (10 min.)
Mix: 310 A
CO₂: 340 A
Ø 1.0-1.6 mm

Page 14-15

Water cooled torches



TBi 241
Classic Series
100% (10 min.)
Mix: 270 A
CO₂: 300 A
Ø 0.8-1.2 mm

Page 16-17



TBi 351
Classic Series
100% (10 min.)
Mix: 270 A
CO₂: 300 A
Ø 0.8-1.2 mm

Page 18-19



TBi 411
Classic Series
100% (10 min.)
Mix: 450 A
CO₂: 500 A
Ø 1.0-1.6 mm

Page 20-21



TBi 7W
Top 2000 Series
100% (10 min.)
Mix: 450 A
CO₂: 500 A
Ø 1.0-1.6 mm

Page 22-23



TBi 511-CC
Top 2000 Series
100% (10 min.)
Mix: 500 A
CO₂: 550 A
Ø 1.2-1.6 mm
with 2-circuit cooling

Page 24-25



Wire guides and
Accessories

Page 26-30

Technical Data

Rating at 60% duty cycle
(10 min. cycle)

- Mixed gas: 300 A
- bei CO₂: 330 A

Cooling method Gas cooling

Wire diameter 1.0 - 1.6 mm

Gas flow 16 l/min

Technical specification according to IEC 60974-7

Connection Euro-Central connector
Other connectors are available upon request.

Torch rating will be reduced when using pulsed-arc power sources.



Contact tips

	Pos.		Part no.
M6	▶ 10	ECu, M6 x 28	340P__1069*
		CuCrZr, M6x28	340P__3069*
		Alu, ECu, M6x28	341P__1069*

	Pos.		Part no.
M8	11	ECu, M8x30	340P__1262*
		CuCrZr, M8x30	340P__3262*
		Alu, ECu, M8x30	341P__1262*

▶ = Standard equipment

* At the blank, please insert suitable information for torch length or wire diameter, e.g. 3 for 3 m or 08 for 0.8 mm.

Tip holders

	Pos.		Part no.
	▶ 20	for contact tip M6	342P006014
		for contact tip M6, 4 mm longer version	342P006114

	Pos.		Part no.
	21	for contact tip M8	342P008014
		for contact tip M8, 6 mm longer version	342P008114

Ordering information for torches

Supplied equipped for steel wire Ø 1.2 mm

TBi 360 Expert	with Euro central connector	3 m	114P321030
		4 m	114P321040
		5 m	114P321050

TBi 360 Expert	with Euro central connector and long trigger	3 m	114P3L1030
		4 m	114P3L1040
		5 m	114P3L1050

Spare parts

Pos.	Description	Part no.
50	Torch neck TBi 360, 50°	114P001001
51	PVC body	600P002018
60	Handle Expert cpl., gas cooled	380P230001
61	Handle Expert cpl., gas cooled, long trigger	380P230002
62	Screw for Expert handle	100P541101
63	Trigger, red, 2 poles	385P021016
64	Trigger, red, 2 poles, long	385P021018

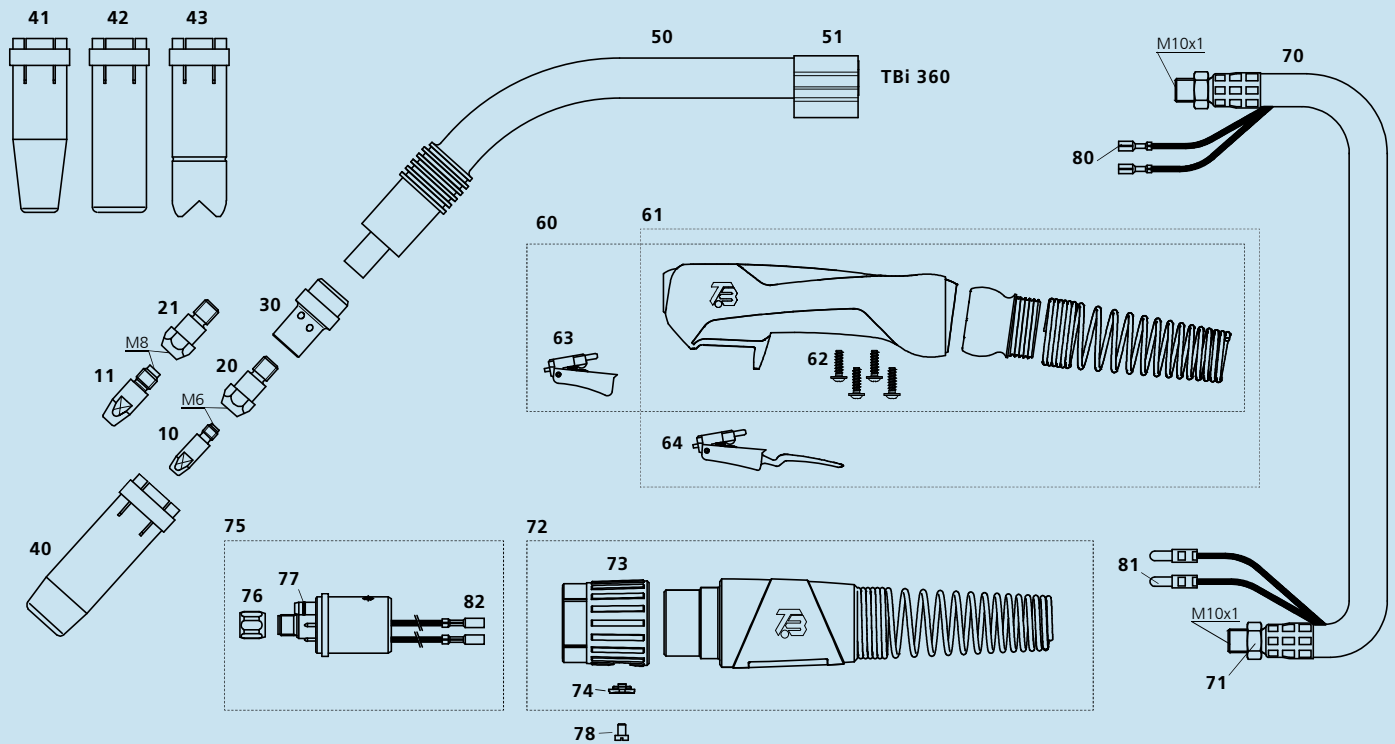

Gas diffuser



Pos.	Description	Part no.
30	thermoset, black, very robust	114P002007
	ceramic, white, extremely heat resistant	114P002005

Gas nozzle

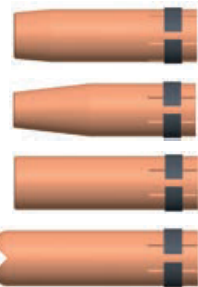

Pos.	Description	Part no.
40	conical, NW 16 mm L= 83.5 mm	345P012010
41	conical, NW 12 mm only for M6 L= 83.5 mm	345P013010
42	cylindrical, NW 20 mm L= 83.5 mm	345P011010
43	spot welding nozzle NW 20 mm L= 90 mm	345P015010

Pos.	Description	Part no.
70	TBi-Flex coaxial cable 50 sqmm	360P5011_0*
71	Hex nut M10x1	101P002005
72	Cable support Expert cpl., gas cooled	700P001064
73	Adaptor nut Expert	700P001010
74	Cap for adaptor nut Expert	700P002059
75	Central adaptor ESG cpl., 2 poles, moveable pins	701P001048
76	Sleeve nut M10x1	701P002005
77	O-Ring 4.0x1.0 mm (gas nipple)	365P100040
78	Screw M4x6	100P008401

Pos.	Description	Part no.
80	Cable lug, flat	375P000023
81	Insulated connector, male, round	375P000004
82	Insulated connector, female, round	375P000003

Ready for Tomorrow.

© 2013 Tbi Industries GmbH. All rights reserved. Subject to change without notice. Excerpts and reprints not permitted. Nr. DOKP110012, 06/2013.

Tbi Industries GmbH
Ruhberg 14
D-35463 Fernwald-Steinbach
P.O. Box 67
D-35461 Fernwald-Steinbach

Tel. + 49 6404 9171-0
Fax. + 49 6404 9171-40
Internet: www.tbi-industries.com
E-mail: info@tbi-industries.com